

TNB-7E

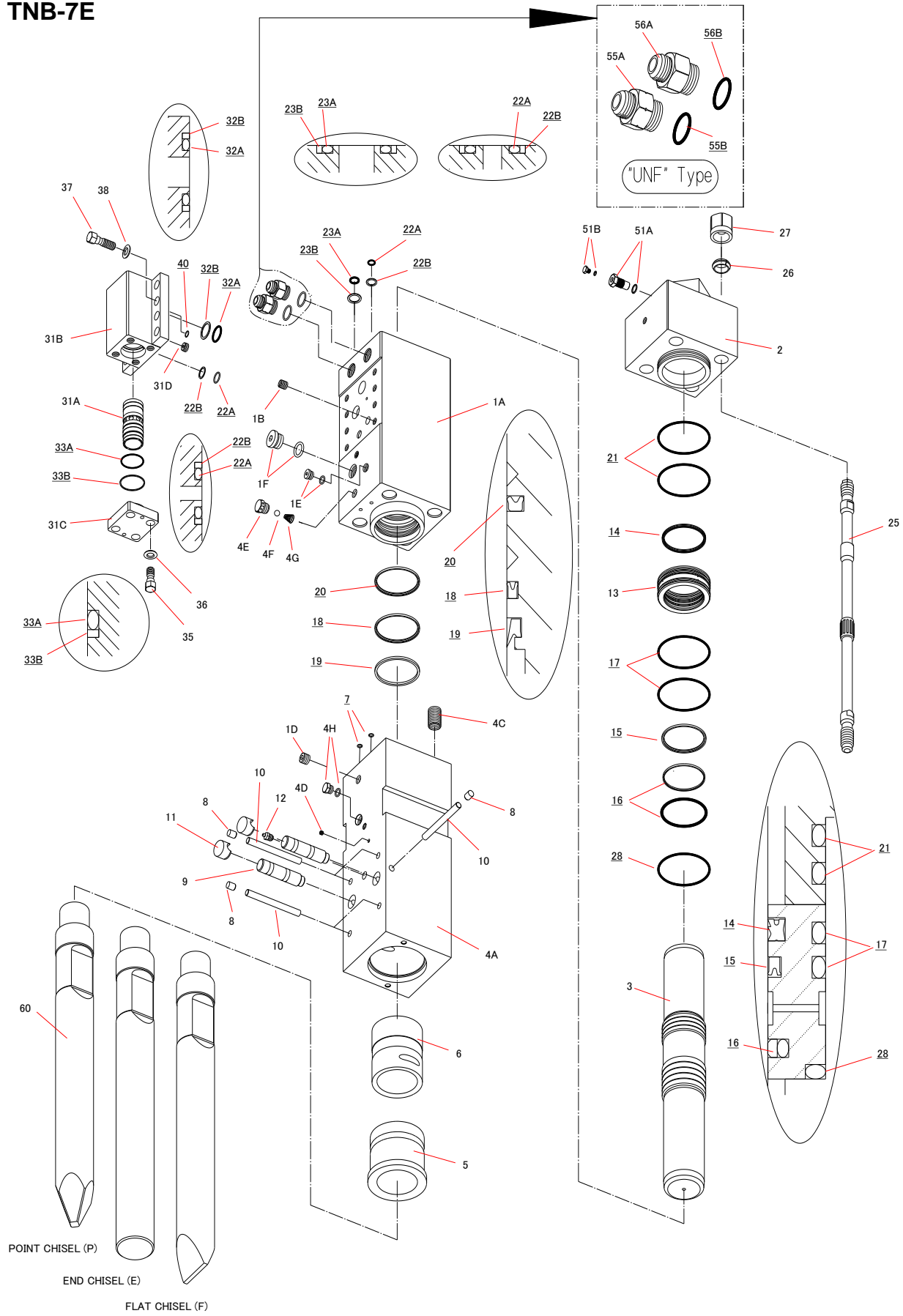

POINT CHISEL (P)
 END CHISEL (E)
 FLAT CHISEL (F)

Parts

2015.01.23
No.9

Sym	Part Code	Description	Q'ty	Ser.No.	Int	Remarks	Kit	Sym	Part Code	Description	Q'ty	Ser.No.	Int	Remarks	Kit
	41513201K	Cylinder CP	1CP	7793~	x			18	131225071	Oil Seal	1	6144~			S
	41513201J	Cylinder CP	1CP	7694~7792	o			19	131219070	Dust Seal	1	6144~			S
	41513201H	Cylinder CP	1CP	7610~7693	x			20	131227071	Buffer Ring	1	6144~			S
	41513201G	Cylinder CP	1CP	6742~7609	o			21	131101078	O-Ring	2	6144~			S
	41513201C	Cylinder CP	1CP	6144~6741				22A	131101029	O-Ring	3	6144~			S
1A	415132020	Cylinder	1	7793~	x		C	22B	131121029	Back Up Ring	3	6144~			S
	415132019	Cylinder	1	7694~7792	x		C	23A	131101042	O-Ring	1	6144~			S
	415132018	Cylinder	1	7610~7693	x		C	23B	131121042	Back Up Ring	1	6144~			S
	415132017	Cylinder	1	6742~7609	x		C	25	415132160	Side Bolt	4	6144~			
	415132016	Cylinder	1	6144~6741			C	26	136306001	Side Bolt Ring	4	6144~			
1B	131019013	Helisert	8	6144~			C	27	134206020	Side Bolt Nut	4	6144~			
1D	134901104	Hex plug	1	7793~			H	28	131108078	O-Ring	1	6144~			S
	134901104	Hex plug	2	7610~7792			C,H	31A	415132200	Control Valve	1	6144~			
	134901104	Hex plug	1	6144~7609			C	31B	415132211	Control Valve Box	1	7793~	x		
1E	134912002	Hex Socket Flange plug	1	6144~			C		415132210	Control Valve Box	1	6144~7792			
1F	134912010	Hex Socket Flange plug	1	7694~			C	31C	415132220	Control Valve Cap	1	6144~			
	134901110	Hex plug	1	6742~7693			C	31D	415132230	Choke Plug	1	6144~			
2	415132030	Cylinder Cover	1	6144~				32A	131101048	O-Ring	2	6144~			S
3	415132040	Piston	1	6144~				32B	131121048	Back Up Ring	2	6144~			S
	41513205H	Chisel Hoder CP	1CP	7610~				33A	131102008	O-Ring	1	6144~			S
	41513205D	Chisel Hoder CP	1CP	6144~7609				33B	131122008	Back Up Ring	1	6144~			S
4A	415132057	Chisel Holder	1	7610~			H	35	131506007	Hex Bolt	4	6144~			
	415132056	Chisel Holder	1	6144~7609			H	36	131313120	Washer	4	6144~			
4C	131036015	Helisert	4	6144~			H	37	131506006	Hex Bolt	8	6144~			
4D	134901101	Hex plug	1	6144~			H	38	131313120	Washer	8	6144~			
4E	415143660	Air Cap	1	7610~			C	40	131108023	O-Ring	1	7793~			S
	415143660	Air Cap	1	6144~7609			H	51	41514130J	Gas Valve CP	1CP	10046~	▲		
4F	130505028	Ball	1	7610~			C		41514130E	Gas Valve CP	1CP	6144~10045			
	130505028	Ball	1	6144~7609			H	51A	41514130G	Gas Valve Body CP	1CP	6144~			G
4G	130806014	Air Cap Spring	1	7610~			C	51B	41514132E	Gas Valve Plug CP	1CP	10046~			G
	130806014	Air Cap Spring	1	6144~7609			H	55A	182092070	Hose Adapter IN "UNF"	1	6144~		1-1/16-12UNF	
4H	182136006	O-Ring Plug	1	6144~			H	55B	131108028	O-Ring	1	6144~			S
5	415132060	Chisel Bushing	1	6144~			H	56A	182092071	Hose Adapter OUT "UNF"	1	6144~		1-1/16-12UNF	
6	415133140	Chisel Holder Bushing	1	6144~			H	56B	131108028	O-Ring	1	6144~			S
7	131101010	O-Ring	2	7610~			S								
	131101010	O-Ring	1	6144~7609			S	60	415133412	Point Chisel (P)	1	10001~	▲	L=1050	
8	136402011	Plug	5	6144~			H		415133410	Point Chisel (P)	1	6144~10000		L=930	
9	415128100	Retainer Pin	2	6144~				61	415133422	End Chisel (E)		10001~	▲	L=1050	
10	415128250	Stopper Pin	5	6144~			H		415133420	End Chisel (E)		6144~10000		L=930	
11	136402037	Retainer Pin Plug	2	6144~				62	415133432	Flat Chisel (F)		10001~	▲	L=1050	
12	135013002	Grease Nipple	1	6144~			H		415133430	Flat Chisel (F)		6144~10000		L=930	
13	415132130	Packing Bushing	1	6144~											
14	131220070	Gas Seal	1	6144~			S		41513280P	Seal Kit	1Set	7793~	▲		
15	131225070	Oil Seal	1	6144~			S		41513280N	Seal Kit	1Set	7694~7792	▲		
16	131230070	Slide Ring S	1	6144~			S		41513280L	Seal Kit	1Set	7610~7693	▲		
17	131101078	O-Ring	2	6144~			S		41513280D	Seal Kit	1Set	6144~7609			

Seal Kit consists of the parts marked "S". (Individual seals NOT sold separately)

Cylinder CP consists of the parts marked "C".

Chisel Holder CP consists of the parts marked "H".
Quantity of the item #8 & 10 required for this CP is 4.

The Plug (No. 1E, 1F, 4H) includes O-ring. (Supplied as Kit ONLY)

Gas Valve CP consists of the parts marked "G". (Item #51A NOT sold separately)

Concerning #55A & #56A HOSE ADAPTER, please check and select proper type of adapter area that is different depend on the market.

O-RING is included to #55A & #56A UNF type HOSE ADAPTER.
(HOSE ADAPTER is not supplied as bare condition. O-ring always comes together)

INT(interchangeability)

o Interchangeable old ⇔ new

△ Interchangeable old → new

▲ Interchangeable old ← new

× Not interchangeable