

TNB-151LU2

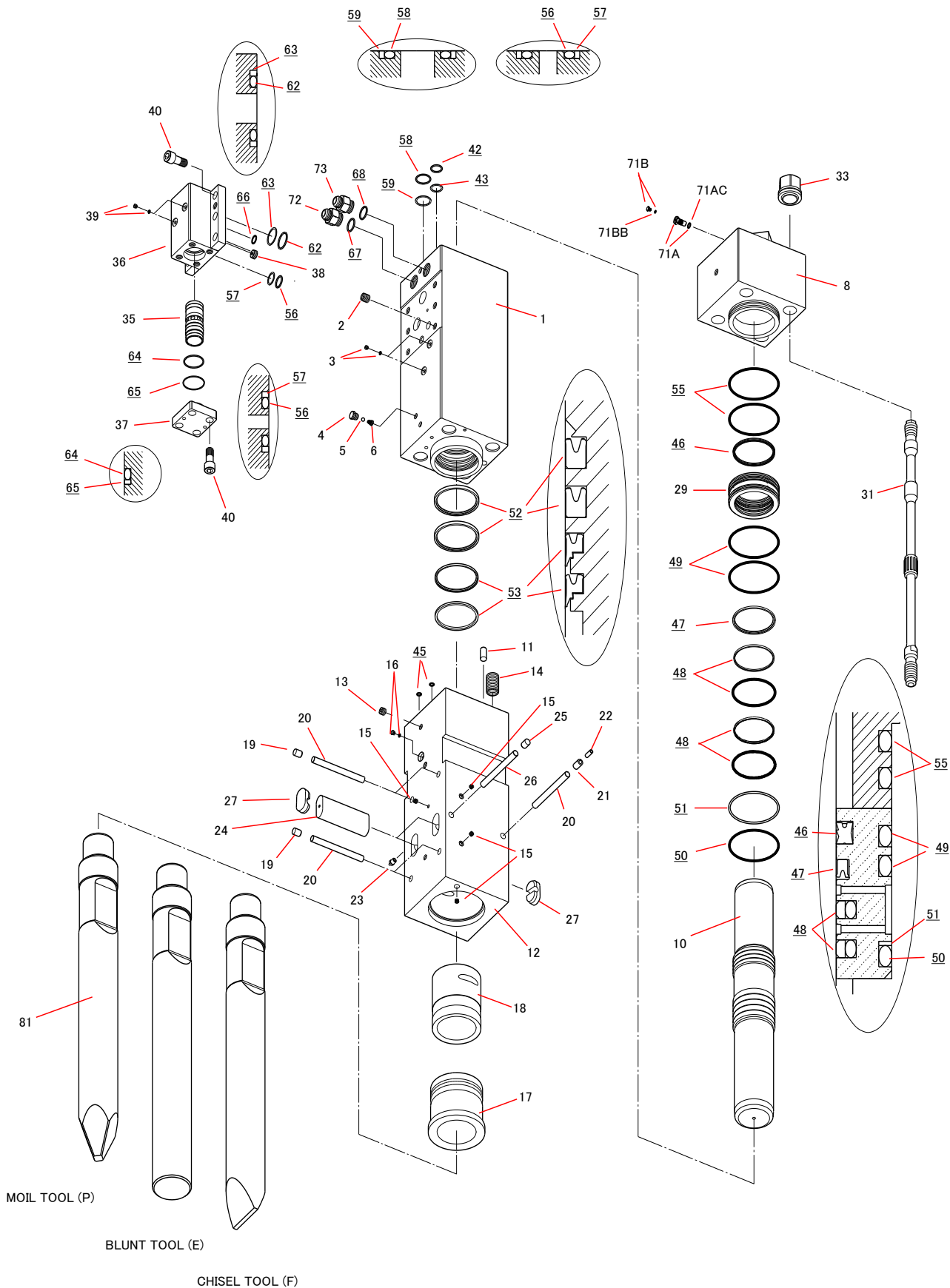

Parts

2018.12.20

No.4

Sym	Part Code	Description	Q'ty	Ser.No.	Int	Remarks	Kit
	41561801D	CYLINDER CP	1	15697-	▲		
	41561801C	CYLINDER CP	1	15011-15696			
1	415618011	CYLINDER	1	15697-	▲		C
	415618010	CYLINDER	1	15011-15696			C
2	131024010	HELISERT	6	15011-			C
3	134912002	HEX SOCKET FLANGE PLUG	2	15011-			C
	41514366A	AIR CAP CP	1	15011~			C
4	415143660	AIR CAP	1	15011-			A,C
5	130505028	BALL	1	15011-			A,C
6	130806014	AIR CAP SPRING	1	15011-			A,C
8	415185030	CYLINDER COVER	1	15011-			
10	415693040	PISTON	1	15011-			
11	415618U30	LOCK PIN	1	15697-			
	41560905E	CHISEL HOLDER CP	1	15697-	▲		
	41560905D	CHISEL HOLDER CP	1	15011-15696			
12	415609051	CHISEL HOLDER	1	15697-	▲		H
	415609050	CHISEL HOLDER	1	15011-15696			H
13	134901104	PLUG	1	15011-			H
14	131042015	HELISERT	4	15011-			H
15	134901102	PLUG	4	15011-			H
16	182136006	O-RING PLUG	1	15011-			H
17	415609060	CHISEL BUSHING	1	15011-			H
18	415148140	CHISEL HOLDER BUSHING	1	15011-			H
19	136402011	PLUG	4	15011-			H
20	415148250	STOPPER PIN	5	15011-			H
21	130620030	SPRING PIN	1	15011-			H
22	130613030	SPRING PIN	1	15011-			H
23	135013002	GREASE NIPPLE	1	15011-			H
24	415186100	RETAINER PIN	2	15011-			
25	136402011	PLUG	1	15011-			
26	415148250	STOPPER PIN	1	15011-			
27	136402040	RETAINER PIN PLUG	4	15011-			
29	415609130	PACKING BUSHING	1	15011-			
31	415185161	SIDE BOLT	4	15705-	▲		
	415185160	SIDE BOLT	4	15011-15704			
32	136306016	SIDE BOLT RING	0	15705-			
	136306016	SIDE BOLT RING	4	15011-15704			
33	134206018	SIDE BOLT NUT	4	15705-	▲		
	134206017	SIDE BOLT NUT	4	15011-15704			
35	415147200	CONTROL VALVE	1	15011-			
36	415694210	CONTROL VALVE BOX	1	15011-			
37	415147221	CONTROL VALVE CAP	1	15011-			
38	415156230	CHOKE PLUG	1	15011-			
39	134912002	HEX SOCKET FLANGE PLUG	2	15011-			
40	131724250	HEX SOCKET HEAD CAP SCREW	10	16374,16385,16387-	▲		
	131506010	HEX BOLT	10	15011-16386 (Ex: 16374,16385)			
41	131313124	WASHER	0	16374,16385,16387-			
	131313124	WASHER	10	15011-16386 (Ex: 16374,16385)			
42	131101034	O-RING	1	15011-			S

Sym	Part Code	Description	Q'ty	Ser.No.	Int	Remarks	Kit
43	131121034	BACK-UP RING	1	15011-			S
45	131101013	O-RING	2	15011-			S
46	131220150	GAS SEAL	1	15011-			S
47	131225150	OIL SEAL	1	15011-			S
48	131230150	SLIDE RING S	2	15011-			S
49	131102029	O-RING	2	15011-			S
50	131102129	O-RING	1	15011-			S
51	131122026	BACK-UP RING	1	15011-			S
52	131225158	OIL SEAL	2	15011-			S
53	131219158	DUST SEAL	2	15011-			S
55	131102029	O-RING	2	15011-			S
56	131101034	O-RING	2	15011-			S,V
57	131121034	BACK-UP RING	2	15011-			S,V
58	131101045	O-RING	1	15011-			S
59	131121045	BACK-UP RING	1	15011-			S
62	131101049	O-RING	2	15011-			S,V
63	131121049	BACK-UP RING	2	15011-			S,V
64	131102010	O-RING	1	15011-			S,V
65	131122010	BACK-UP RING	1	15011-			S,V
66	131108023	O-RING	1	15011-			S
67	131108038	O-RING	1	15011-			S
68	131108038	O-RING	1	15011-			S
	41514130K	GAS VALVE CP	1	15290-	▲		
	41514130J	GAS VALVE CP	1	15011-15289			
71A	41514130L	GAS VALVE BODY CP	1	15290-	▲		G
	41514130G	GAS VALVE BODY CP	1	15011-15289			G
71AC	131101015	O-RING	1	15011-			G
71B	41514132E	GAS VALVE PLUG CP	1	15011-			G
71BB	131101004	O-RING	1	15011-			G
72	136096254	HOSE ADAPTER-IN (WITH O-RING)	1	15011-		1-5/16-12UNF	
73	136096253	HOSE ADAPTER-OUT (WITH O-RING)	1	15011-		1-5/16-12UNF	
81	415186412	MOIL TOOL (P) 135x1230L	1	15011-		L=1230	
82	415186422	BLUNT TOOL (E) 135x1230L	0	15011-		L=1230	
83	415186432	CHISEL TOOL (F) 135x1230L	0	15011-		L=1230	
	41561880D	SEAL KIT	1	15011-			
	41514780G	CONTROL VALVE SEAL KIT	1	15011-			

Air Cap CP consists of part marked "A"
(#4, 5, & 6 NOT sold separately)

Seal Kit consists of the parts marked "S".
(Individual seals NOT sold separately)

Cylinder CP consists of the parts marked "C".

Contral Valve Seal Kit consists of parts marked "V"
(Individual seals NOT sold separately)

Chisel Holder CP consists of the parts marked "H".

INT(interchangiability)

Gas Valve CP consists of the parts marked "G"
(#71A, 71AC & 71BB NOT sold separately)

○ Interchangeable old ↔ new

△ Interchangeable old → new

▲ Interchangeable old ← new

O-RING is included to #72 & #73 UNF type HOSE ADAPTER.

× Not interchangeable