

TNB-30K

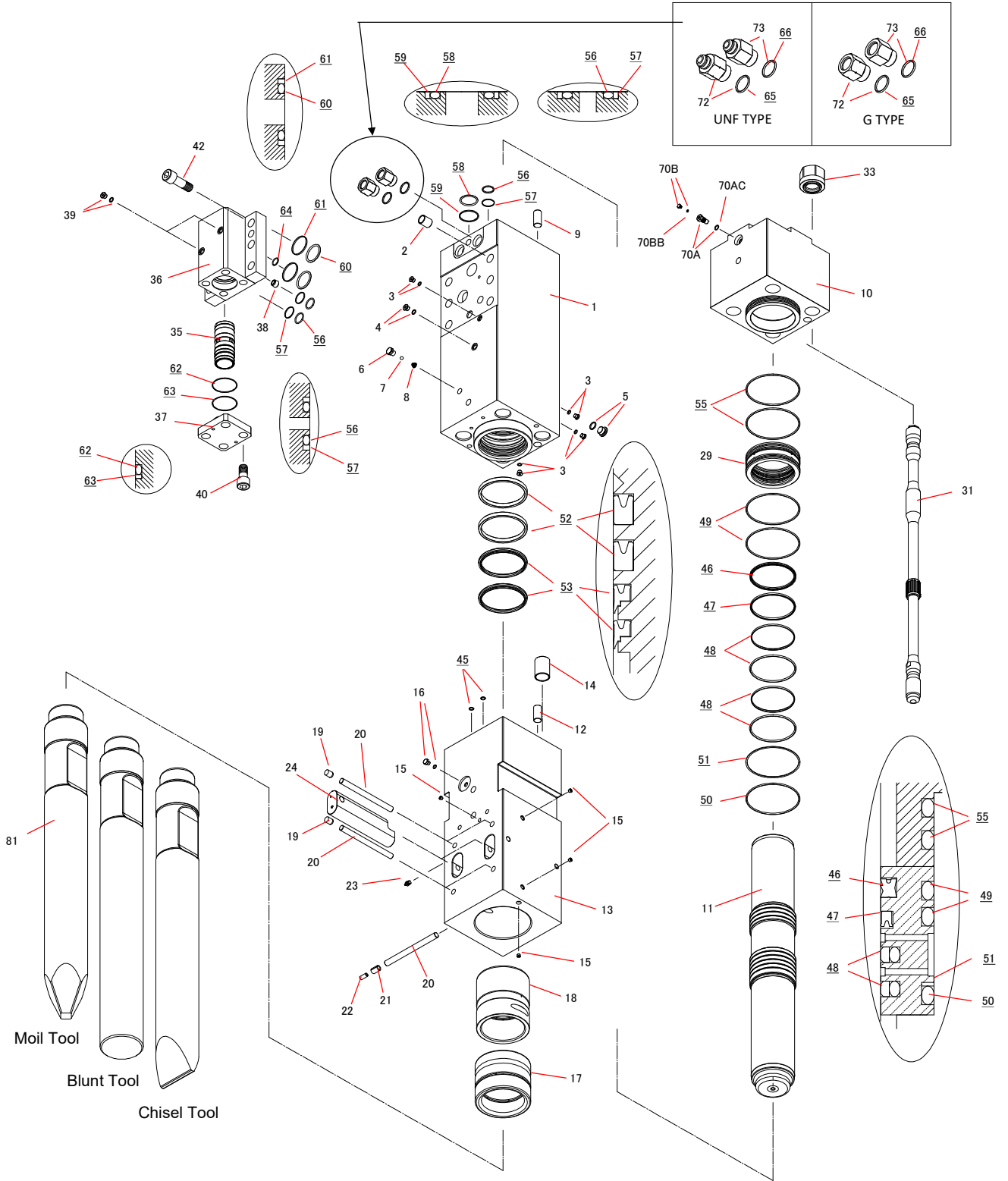

Parts

2021.03.23

No.02

Sym	Part Code	Description	Q'ty	Ser.No.	Int	Remarks	Kit
	41502201C	CYLINDER CP	1	20001-			
1	415022010	CYLINDER	1	20001-			C
2	131030013	HELISERT	6	20001-			C
3	134912002	HEX SOCKET FLANGE PLUG	4	20001-			C
4	134912003	HEX SOCKET FLANGE PLUG	1	20001-			C
5	134912006	HEX SOCKET FLANGE PLUG	1	20001-			C
		AIR CAP CP	1	20001-			C
6	415143660	AIR CAP	1	20001-			A,C
7	130505028	BALL	1	20001-			A,C
8	130806014	AIR CAP SPRING	1	20001-			A,C
9	415615U30	LOCK PIN	1	20001-			
10	415022031	CYLINDER COVER	1	20001-			
11	415022040	PISTON	1	20001-			
12	415615U30	LOCK PIN	1	20001-			
	41502205C	CHISEL HOLDER CP	1	20001-			
13	415022051	CHISEL HOLDER	1	20001-			H
14	131052074	HELISERT	4	20001-			H
15	134901102	PLUG	4	20001-			H
16	182136006	O-RING PLUG	1	20001-			H
17	415022061	CHISEL BUSHING	1	20001-			H
18	415022140	CHISEL HOLDER BUSHING	1	20001-			H
19	136402015	PLUG	4	20001-			H
20	415621251	STOPPER PIN	5	20001-			H
21	130620030	SPRING PIN	1	20001-			H
22	130613030	SPRING PIN	1	20001-			H
23	135013002	GREASE NIPPLE	1	20001-			H
24	415621101	RETAINER PIN	2	20001-			
29	415607130	PACKING BUSHING	1	20001-			
31	415022161	SIDE BOLT	4	20001-			
33	134206024	SIDE BOLT NUT	4	20001-			
35	415156200	CONTROL VALVE	1	20001-			
36	415022210	CONTROL VALVE BOX	1	20001-			
37	415156221	CONTROL VALVE CAP	1	20001-			
38	415621230	CHOKE PLUG	1	20001-			
39	134912003	HEX SOCKET FLANGE PLUG	2	20001-			
40	131730260	HEX SOCKET HEAD CAP SCREW	4	20001-			
42	131730290	HEX SOCKET HEAD CAP SCREW	6	20001-			
	41502280D	SEAL KIT	1	20001-			
45	131101013	O-RING	2	20001-			S
46	131220220	GAS SEAL	1	20001-			S
47	131225220	OIL SEAL	1	20001-			S
48	131230220	SLIDE RING S	2	20001-			S
49	131102033	O-RING	2	20001-			S
50	131102133	O-RING	1	20001-			S
51	131122033	BACK-UP RING	1	20001-			S
52	131225239	OIL SEAL	2	20001-			S
53	131219239	DUST SEAL	2	20001-			S
55	131102033	O-RING	2	20001-			S
56	131101036	O-RING	3	20001-			V,S
57	131121036	BACK-UP RING	3	20001-			V,S
58	131101055	O-RING	1	20001-			S
59	131121055	BACK-UP RING	1	20001-			S
60	131101057	O-RING	2	20001-			V,S
61	131121057	BACK-UP RING	2	20001-			V,S
62	131102013	O-RING	1	20001-			V,S

Sym	Part Code	Description	Q'ty	Ser.No.	Int	Remarks	Kit
63	131122013	BACK-UP RING	1	20001-			V,S
64	131108023	O-RING	1	20001-			S
65	131108038	O-RING	1	20001-			S
66	131108038	O-RING	1	20001-			S
	41514130K	GAS VALVE CP	1	20001-			
70A	41514130L	GAS VALVE BODY CP	1	20001-			G
70AC	131101015	O-RING	1	20001-			G
70B	41514132E	GAS VALVE PLUG CP	1	20001-			G
70BB	131101004	O-RING	1	20001-			G
72	41562135A	HOSE ADAPTER IN (G1") (WITH O-RING)	1	20001-		G1"	
72	415022J3A	HOSE ADAPTER IN (1-5/16-12UNF) (WITH O-RING)	1	20001-		1-5/16-12UNF	
73	41515648E	HOSE ADAPTER OUT (G1") (WITH O-RING)	1	20001-		G1"	
73	136096256	HOSE ADAPTER OUT (1-5/16-12UNF) (WITH O-RING)	1	20001-		1-5/16-12UNF	
81	415022410	MOIL TOOL (P)	1	20001-		L=1350	
	415022420	BLUNT TOOL (E)	0	20001-		L=1350	
	415022430	CHISEL TOOL (F)	0	20001-		L=1350	

Air Cap CP consists of part marked "A"
(#6, 7, & 8 NOT sold separately)

Cylinder CP consists of the parts marked "C".

Chisel Holder CP consists of the parts marked "H".

Gas Valve CP consists of the parts marked "G"
(#70A, 70AC & 70BB NOT sold separately)

O-RING is included to #72 & #73

Seal Kit consists of the parts marked "S".
(Individual seals NOT sold separately)

Contral Valve Seal Kit consists of parts marked "V"
(Individual seals NOT sold separately)

INT(interchangeability)
 ○ Interchangeable old ⇔ new
 △ Interchangeable old → new
 ▲ Interchangeable old ← new
 × Not interchangeable