

# TNB-400LU2

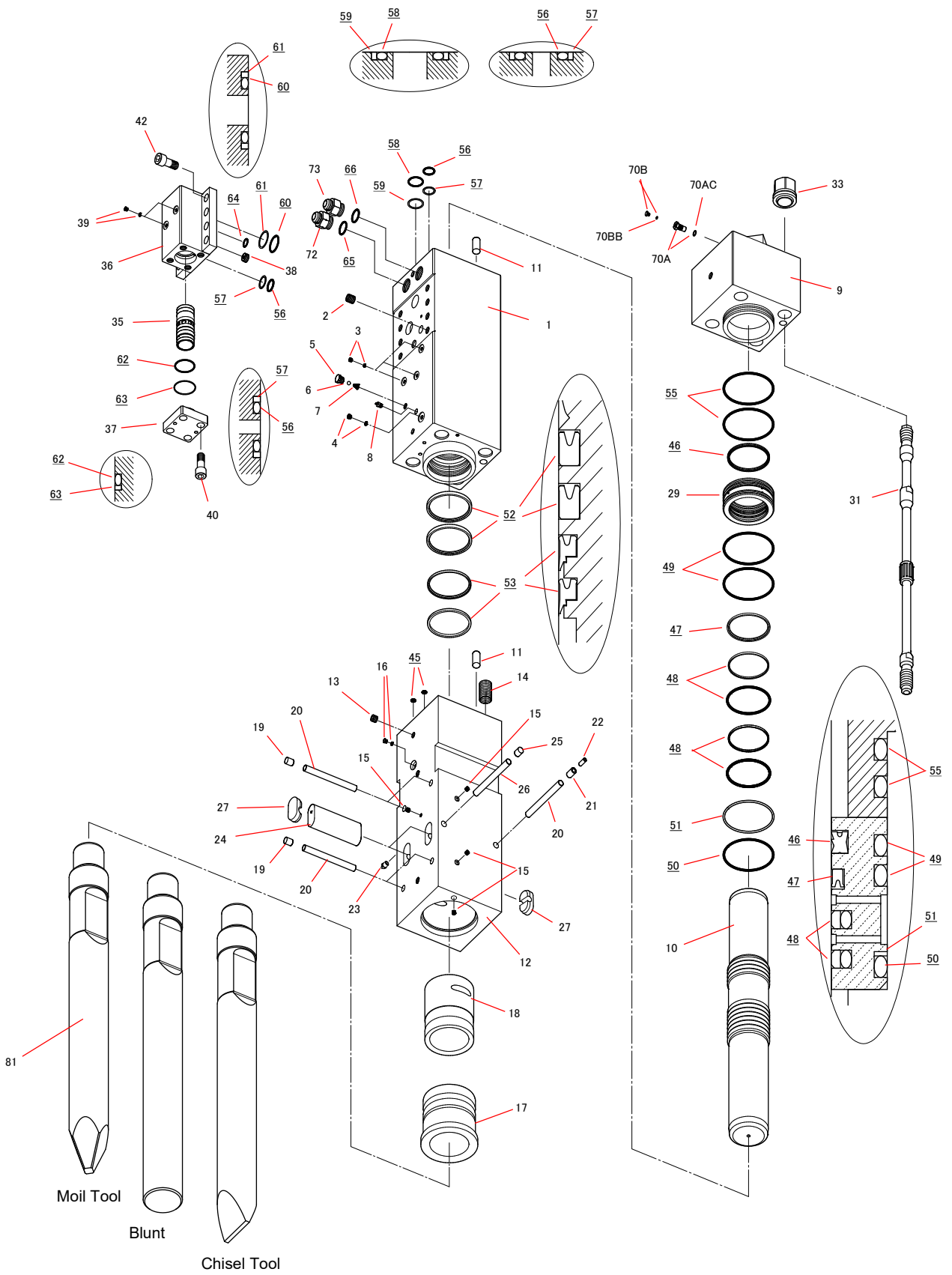

# Parts

2023.05.07

No.2

Sym	Part Code	Description	Q'ty	Ser.No.	Int	Remarks	Kit
	41502801D	CYLINDER CP	1	15002-			
1	415028011	CYLINDER	1	15002-			C
2	131033012	HELISERT	8	15002-			C
3	134912002	HEX SOCKET FLANGE PLUG	3	15002-			C
4	134912003	HEX SOCKET FLANGE PLUG	1	15002-			C
		AIR CAP CP	1	15002-			C
5	415143660	AIR CAP	1	15002-			A,C
6	130505028	BALL	1	15002-			A,C
7	130806014	AIR CAP SPRING	1	15002-			A,C
8	135013002	GREASE NIPPLE	1	15002-			C
9	415197032	CYLINDER COVER	1	15002-			
10	415197041	PISTON	1	15002-			
11	415615U30	LOCK PIN	2	15002-			
	41565705E	CHISEL HOLDER CP	1	15002-			
12	415657052	CHISEL HOLDER	1	15002-			H
13	134901104	PLUG	1	15002-			H
14	131064015	HELISERT	4	15002-			H
15	134901102	PLUG	4	15002-			H
16	182136006	O-RING PLUG	1	15002-			H
17	415657060	CHISEL BUSHING	1	15002-			H
18	415161140	CHISEL HOLDER BUSHING	1	15002-			H
19	136402015	PLUG	4	15002-			H
20	415161251	STOPPER PIN	5	15002-			H
21	130620030	SPRING PIN	1	15002-			H
22	130613030	SPRING PIN	1	15002-			H
23	135013002	GREASE NIPPLE	1	15002-			H
24	415198100	RETAINER PIN	2	15002-			
25	136402015	PLUG	1	15002-			
26	415161251	STOPPER PIN	1	15002-			
27	136402044	RETAINER PIN PLUG	4	15002-			
29	415657130	PACKING BUSHING	1	15002-			
31	415197160	SIDE BOLT	4	15002-			
33	134206039	SIDE BOLT NUT	4	15002-			
35	415161200	CONTROL VALVE	1	15002-			
36	415681210	CONTROL VALVE BOX	1	15002-			
37	415161221	CONTROL VALVE CAP	1	15002-			
38	415161230	CHOKE PLUG	1	15002-			
39	134912002	HEX SOCKET FLANGE PLUG	2	15002-			
40	131733280	HEX SOCKET HEAD CAP SCREW	4	15002-			
42	131733300	HEX SOCKET HEAD CAP SCREW	8	15002-			
	41565780D	SEAL KIT	1	15002-			
45	131101013	O-RING	2	15002-			S
46	131220380	GAS SEAL	1	15002-			S
47	131225380	OIL SEAL	1	15002-			S
48	131230380	SLIDE RING S	2	15002-			S
49	131102038	O-RING	2	15002-			S
50	131102138	O-RING	1	15002-			S
51	131122038	BACK-UP RING	1	15002-			S
52	131225602	OIL SEAL	2	15002-			S
53	131219601	DUST SEAL	2	15002-			S
55	131102038	O-RING	2	15002-			S
56	131101045	O-RING	3	15002-			V,S
57	131121045	BACK-UP RING	3	15002-			V,S
58	131101058	O-RING	1	15002-			S
59	131121058	BACK-UP RING	1	15002-			S

Sym	Part Code	Description	Q'ty	Ser.No.	Int	Remarks	Kit
60	131101063	O-RING	2	15002-			V,S
61	131121063	BACK-UP RING	2	15002-			V,S
62	131102018	O-RING	1	15002-			V,S
63	131122018	BACK-UP RING	1	15002-			V,S
64	131108023	O-RING	1	15002-			S
65	131108043	O-RING	1	15002-			S
66	131108043	O-RING	1	15002-			S
	41514130K	GAS VALVE CP	1	15002-			
70A	41514130L	GAS VALVE BODY CP	1	15002-			G
70AC	131101015	O-RING	1	15002-			G
70B	41514132E	GAS VALVE PLUG CP	1	15002-			G
70BB	131101004	O-RING	1	15002-			G
72	136096259	HOSE ADAPTER IN (1-5/8-12UNF)	1	15002-		1-5/8-12UNF	
73	136096258	HOSE ADAPTER OUT (1-5/8-12UNF)	1	15002-		1-5/8-12UNF	
81	415198412	MOIL TOOL 178x1700L	1	15002-		L=1700	
	415198422	BLUNT TOOL 178x1700L	0	15002-		L=1700	
	415198432	CHISEL TOOL 178x1700L	0	15002-		L=1700	

Air Cap CP consists of part marked "A"  
(#5, 6, & 7 NOT sold separately)

Cylinder CP consists of the parts marked "C".

Chisel Holder CP consists of the parts marked "H".

Gas Valve CP consists of the parts marked "G"  
(#70A, 70AC & 70BB NOT sold separately)

O-RING is included to #72 & #73

Seal Kit consists of the parts marked "S".  
(Individual seals NOT sold separately)

Contral Valve Seal Kit consists of parts marked "V"  
(Individual seals NOT sold separately)

INT(interchangeability)

○ Interchangeable old ↔ new

△ Interchangeable old → new

▲ Interchangeable old ← new

× Not interchangeable