

TNB-40K

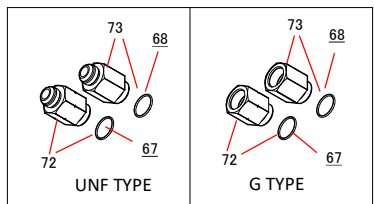
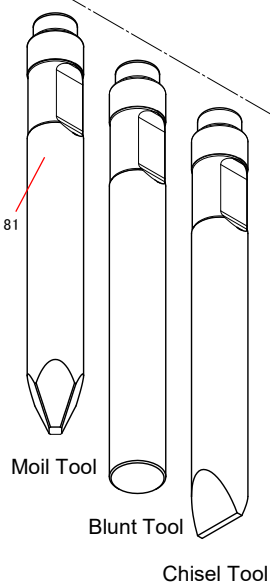
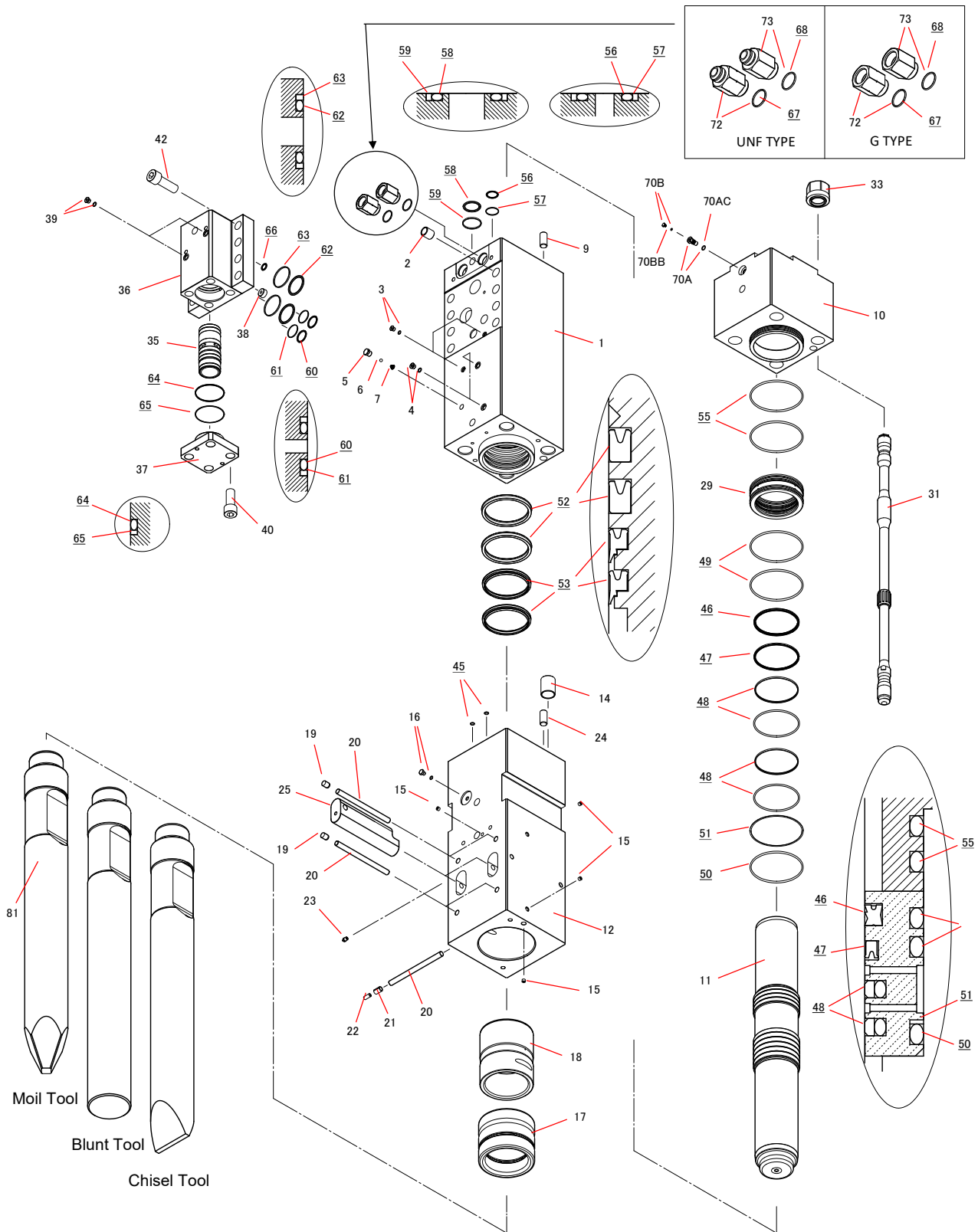

Parts

2021.04.22

No.1

Sym	Part Code	Description	Q'ty	Ser.No.	Int	Remarks	Kit
	41502301C	CYLINDER CP	1	20001-			
1	415023010	CYLINDER	1	20001-			C
2	131033012	HELISERT	8	20001-			C
3	134912002	HEX SOCKET FLANGE PLUG	2	20001-			C
4	134912003	HEX SOCKET FLANGE PLUG	2	20001-			C
		AIR CAP CP	1	20001-			C
5	415143660	AIR CAP	1	20001-			A,C
6	130505028	BALL	1	20001-			A,C
7	130806014	AIR CAP SPRING	1	20001-			A,C
9	415615U30	LOCK PIN	1	20001-			
10	415023030	CYLINDER COVER	1	20001-			
11	415023040	PISTON	1	20001-			
	41502305C	CHISEL HOLDER CP	1	20001-			
12	415023050	CHISEL HOLDER	1	20001-			H
14	131052074	HELISERT	4	20001-			H
15	134901102	PLUG	4	20001-			H
16	182136006	O-RING PLUG	1	20001-			H
17	415023060	CHISEL BUSHING	1	20001-			H
18	415023140	CHISEL HOLDER BUSHING	1	20001-			H
19	136402015	PLUG	4	20001-			H
20	415023250	STOPPER PIN	5	20001-			H
21	130620030	SPRING PIN	1	20001-			H
22	130613030	SPRING PIN	1	20001-			H
23	135013002	GREASE NIPPLE	1	20001-			H
24	415615U30	LOCK PIN	1	20001-			
25	415023100	RETAINER PIN	2	20001-			
29	415023130	PACKING BUSHING	1	20001-			
31	415023160	SIDE BOLT	4	20001-			
33	134206024	SIDE BOLT NUT	4	20001-			
35	415161200	CONTROL VALVE	1	20001-			
36	415023210	CONTROL VALVE BOX	1	20001-			
37	415161221	CONTROL VALVE CAP	1	20001-			
38	415159230	CHOKE PLUG	1	20001-			
39	134912003	HEX SOCKET FLANGE PLUG	2	20001-			
40	131733280	HEX SOCKET HEAD CAP SCREW	4	20001-			
42	131733300	HEX SOCKET HEAD CAP SCREW	8	20001-			
	41502380D	SEAL KIT	1	20001-			
45	131101013	O-RING	2	20001-			S
46	131220300	GAS SEAL	1	20001-			S
47	131225300	OIL SEAL	1	20001-			S
48	131230300	SLIDE RING S	2	20001-			S
49	131102036	O-RING	2	20001-			S
50	131102136	O-RING	1	20001-			S
51	131122036	BACK-UP RING	1	20001-			S
52	131225313	OIL SEAL	2	20001-			S
53	131219313	DUST SEAL	2	20001-			S
55	131102036	O-RING	2	20001-			S
56	131101042	O-RING	1	20001-			S
57	131121042	BACK-UP RING	1	20001-			S
58	131101057	O-RING	1	20001-			S
59	131121057	BACK-UP RING	1	20001-			S
60	131101045	O-RING	2	20001-			V,S
61	131121045	BACK-UP RING	2	20001-			V,S
62	131101063	O-RING	2	20001-			V,S
63	131121063	BACK-UP RING	2	20001-			V,S

Sym	Part Code	Description	Q'ty	Ser.No.	Int	Remarks	Kit
64	131102018	O-RING	1	20001-			V,S
65	131122018	BACK-UP RING	1	20001-			V,S
66	131108023	O-RING	1	20001-			S
67	131108043	O-RING	1	20001-			S
68	131108043	O-RING	1	20001-			S
	41514130K	GAS VALVE CP	1	20001-			
70A	41514130L	GAS VALVE BODY CP	1	20001-			G
70AC	131101015	O-RING	1	20001-			G
70B	41514132E	GAS VALVE PLUG CP	1	20001-			G
70BB	131101004	O-RING	1	20001-			G
72	41502335A	HOSE ADAPTER IN (G1") (WITH O-RING)	1	20001-		G1"	
72	41519735A	HOSE ADAPTER IN (G1-1/4) (WITH O-RING)	1	20001-		G1-1/4	
72	136096259	HOSE ADAPTER IN (1-5/8-12UNF) (WITH O-RING)	1	20001-		1-5/8-12UNF	
73	41560848A	HOSE ADAPTER OUT (G1") (WITH O-RING)	1	20001-		G1"	
73	41519448A	HOSE ADAPTER OUT (G1-1/4) (WITH O-RING)	1	20001-		G1-1/4	
73	136096258	HOSE ADAPTER OUT (1-5/8-12UNF) (WITH O-RING)	1	20001-		1-5/8-12UNF	
81	415023410	MOIL TOOL	1	20001-		L=1500	
	415023420	BLUNT TOOL	0	20001-		L=1500	
	415023430	CHISEL TOOL	0	20001-		L=1500	

Air Cap CP consists of part marked "A"
(#5, 6, & 7 NOT sold separately)

Cylinder CP consists of the parts marked "C".

Chisel Holder CP consists of the parts marked "H".

Gas Valve CP consists of the parts marked "G"
(#70A, 70AC & 70BB NOT sold separately)

O-RING is included to #72 & #73

Seal Kit consists of the parts marked "S".
(Individual seals NOT sold separately)

Conral Valve Seal Kit consists of parts marked "V"
(Individual seals NOT sold separately)

INT(interchangeability)

○ Interchangeable old ↔ new

△ Interchangeable old → new

▲ Interchangeable old ← new

× Not interchangeable